

MODEL	ENCLOSURE WEIGHT KG [LBS]
STEEL WEATHER	261 [575]
STEEL SOUND	272 [600]
ALUMINIUM SOUND	170 [375]

NOTE:

- IF TANK IS ORDERED, ENCLOSURE MOUNTS DIRECTLY TO TANK
- TANK MAY EXTEND BEYOND ENCLOSURE (DISCHARGE END ONLY)

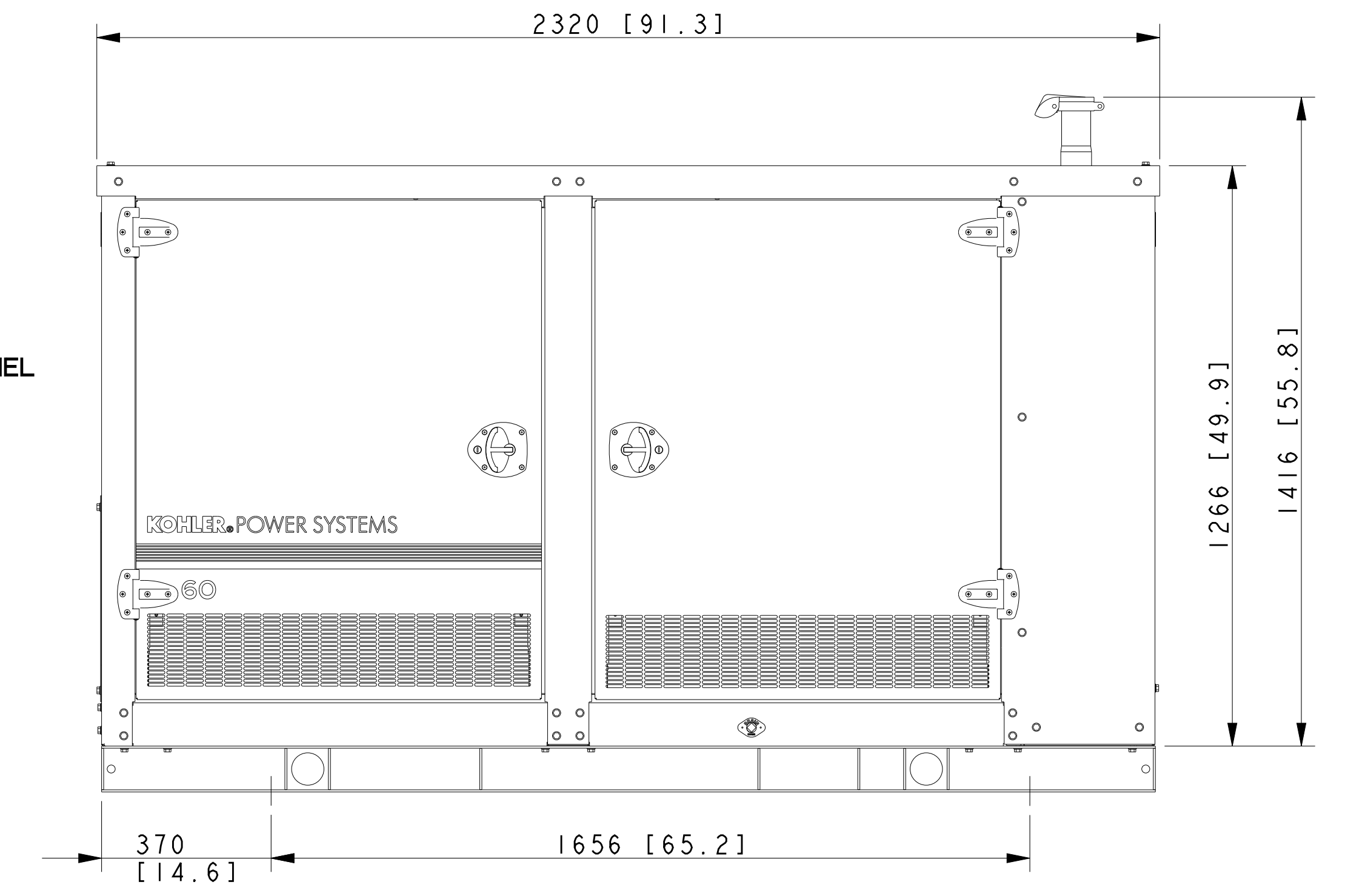
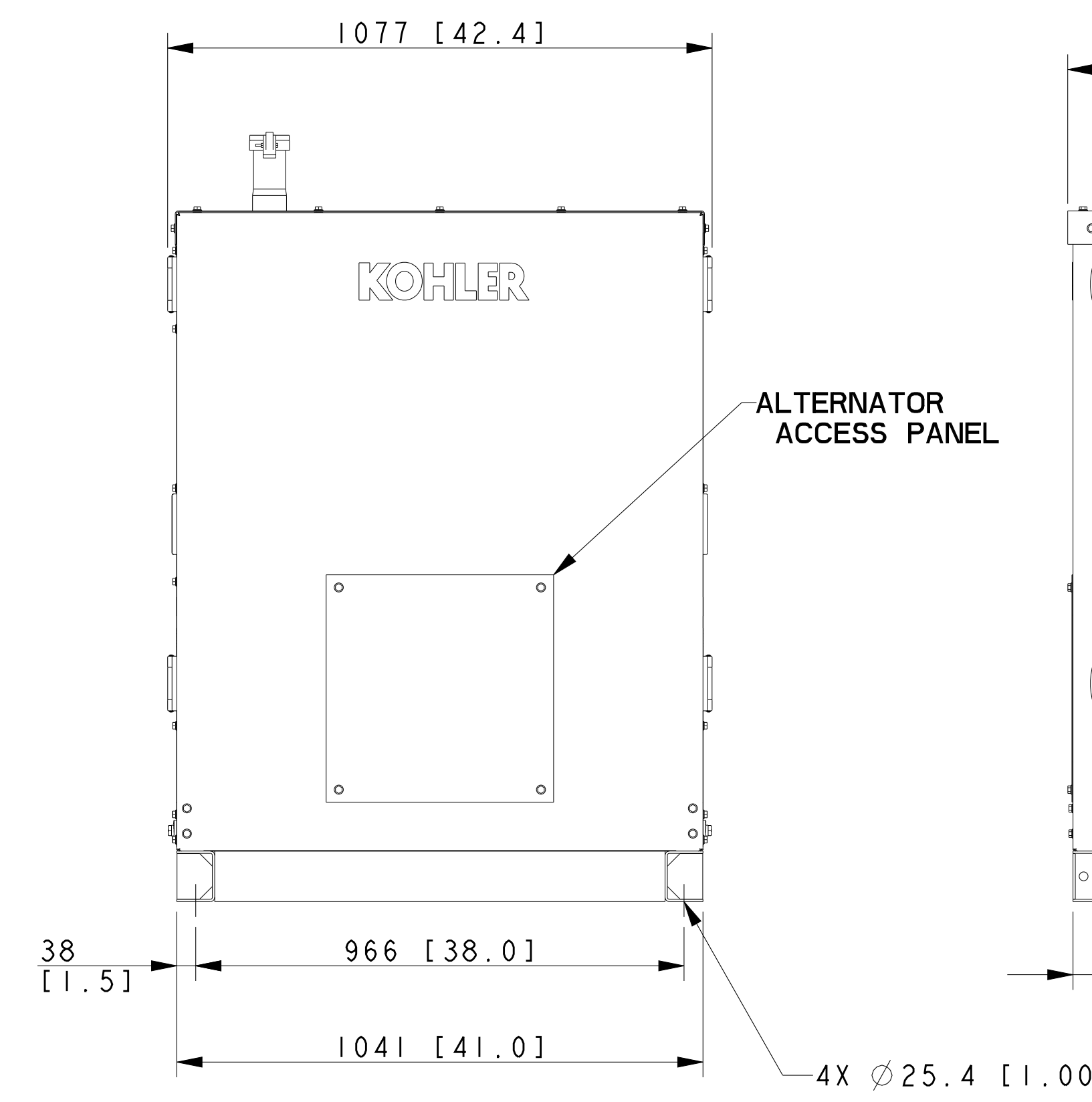
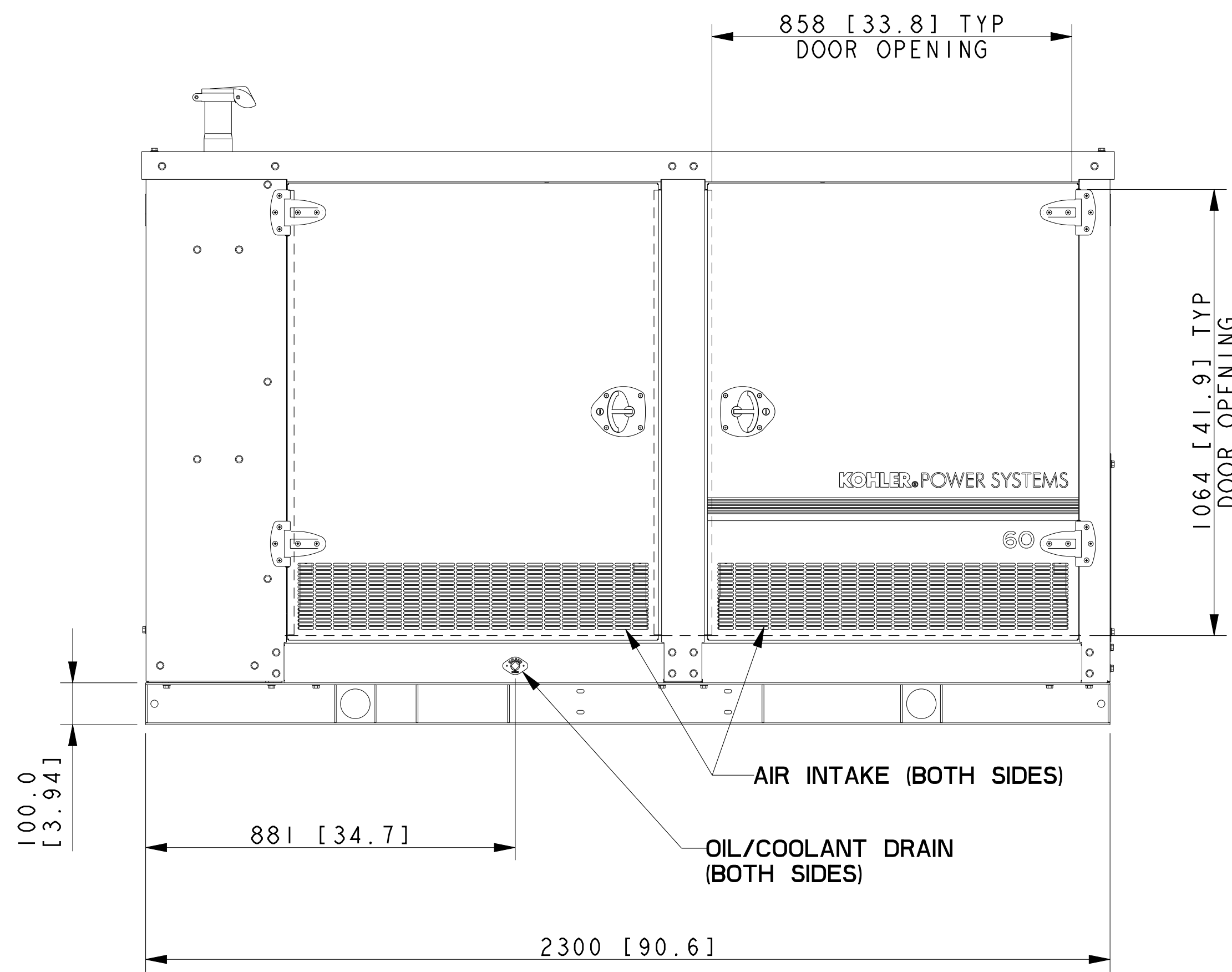
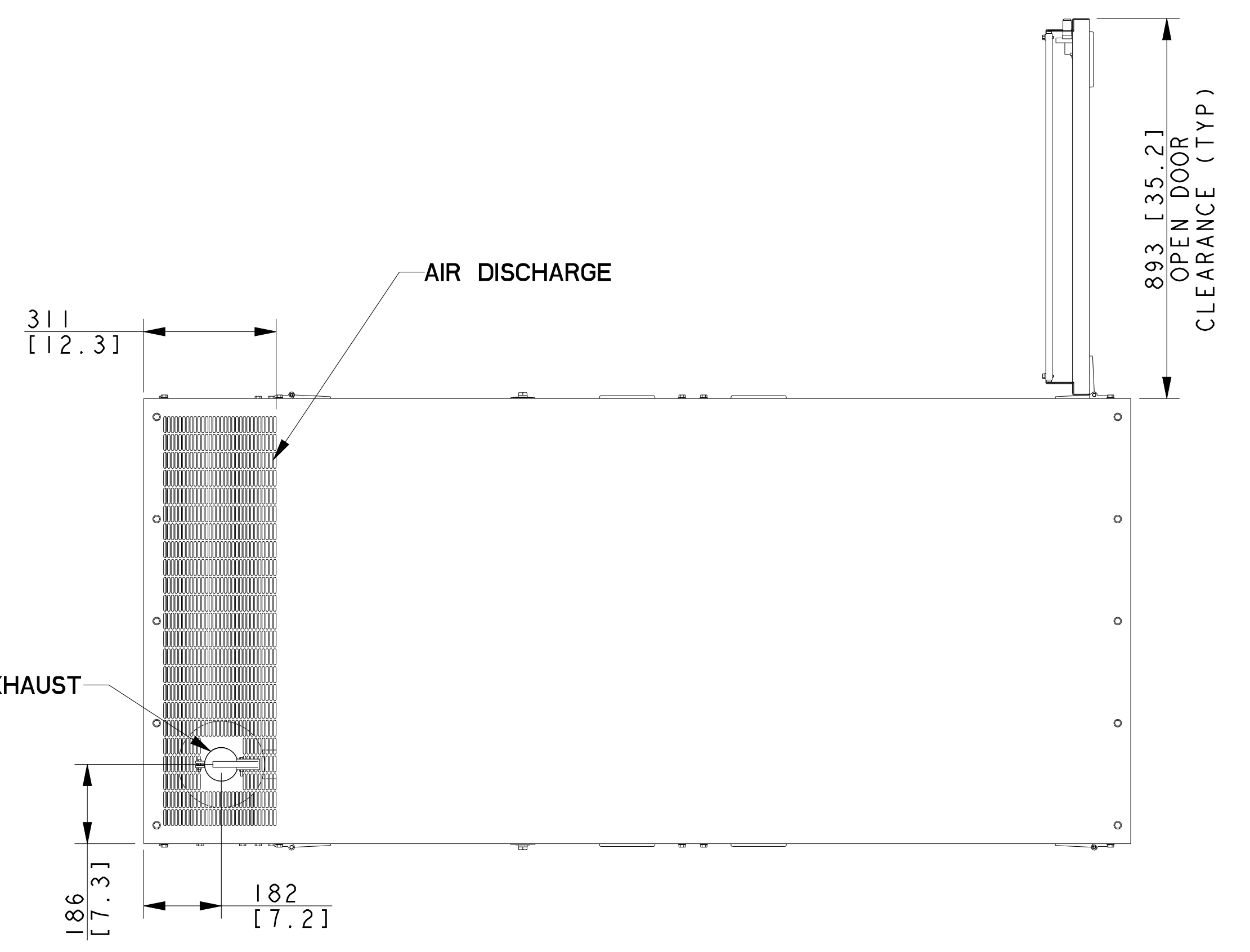

DIMENSIONS IN [] ARE IN ENGLISH EQUIVALENTS.

20 MODEL, 60HZ, 4P4
 30MODEL, 60 HZ, 4P5/4P7/4Q4
 40 MODEL, 60 HZ, 4P5
 50 MODEL, 60 HZ, 4P7/4P8/4Q10
 60 MODEL, 60 HZ, 4P8/4P10/4V7
 RECONNECTABLE,
 IMPROVED MOTOR STARTING (IMS) RECON. & 600V ALTERNATORS
 JOHN DEERE, 4024TF/4024 HF/5030HF, TIER III

REV	DATE	ON COMPOSITE DWGS. SEE PART NO. FOR REVISION LEVEL	BY	UNLESS OTHERWISE SPECIFIED - 1) DIMENSIONS ARE IN MILLIMETERS 2) TOLERANCES ARE:
B	11-10-08	(D-4) MODEL 407 ADDED, 240 GAL WAS 200, METRIC CONVERSIONS CORRECTED [86220]	SAM	
C	2-24-09	ALL VIEWS UPDATED AND REDIMENSIONED. [86807]	GFR	
D	6-1-09	(D-8) 311 WAS 312 (B-1) 1416 WAS 1293 [87272]	SAM	
E	3-9-10	(A-8) 100 WAS 'A', (D-2) TABLE REMOVED, (D-2) NEW TABLE ADDED, (B-4) DIMENSIONS FOR ACCESS PANEL REMOVED [89197]	PKD	

APPROVALS	DATE
DRAWN JMN	3-5-08
CHECKED CWF	3-5-08
APPROVED RJD	3-5-08

KOHLER CO.	METRIC	PRO-E
POWER SYSTEMS, KOHLER, WI 53044 U.S.A.		
THIS DRAWING IN DESIGN AND DETAIL IS KOHLER CO. PROPERTY AND MUST NOT BE USED EXCEPT IN CONNECTION WITH KOHLER CO. WORK. ALL RIGHTS OF DESIGN OR INVENTION ARE RESERVED.		
TITLE: DIMENSION PRINT		
20 - 60 KW JD		
SCALE 0.100	CAD NO.	SHEET 1 of 1
DWG NO. ADV-7429		D